

PIPE CHECK VALVES

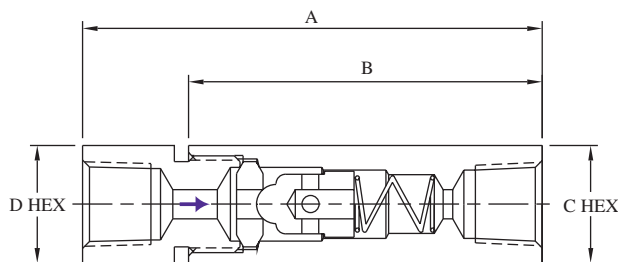

BuTech ball check valves prevent reverse flow where leak-tight shutoff is not necessary. Standard materials of construction are 316 stainless steel with 17-4PH poppet for longer life, and 300 series stainless steel spring.

Note: For 316 stainless steel wetted parts, add **-316WP** to the catalog number.

Cracking pressure: 15 PSI (1 bar) approximate

Operating Temperature Range:

-420° to +1200°F

(-251° to +648°C)

BALL CHECK VALVES

| Catalog Number | Connection | MAWP | Cv | A | B | C | D |
|----------------|------------|------------------------|------|------------------|------------------|-----------------|-----------------|
| FPBC2 | 1/8" NPT | 15,000 PSI 1030 bar | 0.15 | 2.62" (66.5) | 2.12" (53.8) | 0.63" (16.0) | 0.50" (12.7) |
| FPBC4 | 1/4" NPT | 15,000 PSI 1030 bar | 0.63 | 2.94" (74.7) | 2.26" (57.4) | 0.75" (19.1) | 0.75" (19.1) |
| FPBC6 | 3/8" NPT | 15,000 PSI 1030 bar | 0.80 | 3.54" (89.9) | 2.62" (66.5) | 1.12" (28.4) | 1.00" (25.4) |
| FPBC8 | 1/2" NPT | 15,000 PSI 1030 bar | 2.30 | 4.32" (109.7) | 3.50" (88.9) | 1.38" (35.1) | 1.38" (35.1) |
| FPBC12 | 3/4" NPT | 10,000 PSI 690 bar | 3.40 | 5.89" (149.6) | 4.75" (120.7) | 1.75" (44.5) | 1.50" (38.1) |
| FPBC16 | 1" NPT | 10,000 PSI 690 bar | 5.20 | 7.29" (185.2) | 5.75" (146.1) | 2.12" (53.8) | 1.75" (44.5) |

To order a valve with a cracking pressure other than the standard 15 PSI, add the cracking pressure to the end of the catalog number. Example: An FPBC8 with 50 PSI cracking pressure would be ordered as **FPBC8-50**.

Cracking pressures available up to 100 PSI (7 bar)

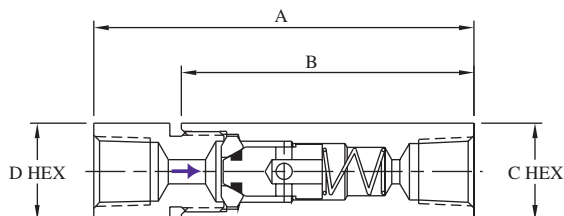

BuTech o-ring check valves reliably prevent backflow where leak-tight shutoff for liquids or gases is required. Standard materials of construction are 316 stainless steel with Buna-N o-ring and 300 series stainless steel spring.

Cracking pressure: 15 PSI (1 bar) approximate

Operating Temperature Ranges:

| O-ring Material | Operating Temperature Range | Catalog Suffix |
|-----------------|-----------------------------------|----------------|
| Buna-N | -65° to +250°F (-54° to +121°C) | ---- |
| Viton | -40° to +500°F (-40° to +260°C) | -VA |
| Teflon | -320° to +400°F (-195° to +204°C) | -TFE |
| Kalrez | -20° to +550°F (-29° to +288°C) | -HT |

O-RING CHECK VALVES

| Catalog Number | Connection | MAWP | Cv | A | B | C | D |
|----------------|------------|------------------------|------|------------------|------------------|-----------------|-----------------|
| FPSC2 | 1/8" NPT | 15,000 PSI 1030 bar | 0.15 | 2.62" (66.5) | 2.12" (53.8) | 0.63" (16.0) | 0.50" (12.7) |
| FPSC4 | 1/4" NPT | 15,000 PSI 1030 bar | 0.63 | 2.94" (74.7) | 2.26" (57.4) | 0.75" (19.1) | 0.75" (19.1) |
| FPSC6 | 3/8" NPT | 15,000 PSI 1030 bar | 0.80 | 3.54" (89.9) | 2.62" (66.5) | 1.12" (28.4) | 1.00" (25.4) |
| FPSC8 | 1/2" NPT | 15,000 PSI 1030 bar | 2.30 | 4.32" (109.7) | 3.50" (88.9) | 1.38" (35.1) | 1.38" (35.1) |
| FPSC12 | 3/4" NPT | 10,000 PSI 690 bar | 3.40 | 5.89" (149.6) | 4.75" (120.7) | 1.75" (44.5) | 1.50" (38.1) |
| FPSC16 | 1" NPT | 10,000 PSI 690 bar | 5.20 | 7.29" (185.2) | 5.75" (146.1) | 2.12" (53.8) | 1.75" (44.5) |

To order a valve with a cracking pressure other than the standard 15 PSI, add the cracking pressure to the end of the catalog number. Example: A FPSC4 with 40 PSI cracking pressure would be ordered as **FPSC4-40**.

Cracking pressures available up to 100 PSI (7 bar)



All dimensions are for reference only and are subject to change.
Dimensions in parentheses are millimeters (mm)

HIGH PRESSURE CHECK VALVES

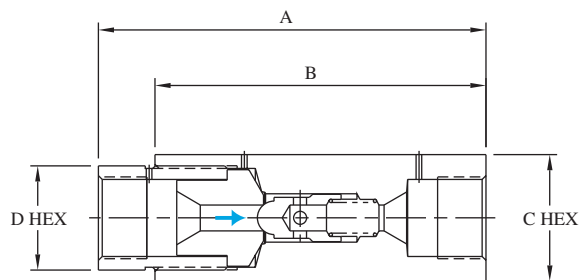

BuTech ball check valves prevent reverse flow where leak-tight shutoff is not necessary. Standard materials of construction are 316 stainless steel with 17-4PH poppet for longer life, and 300 series stainless steel spring.

Note: For 316ss wetted parts, add **-316WP** to the catalog number.

Cracking pressure: 15 PSI (1 bar) approximate

Operating Temperature Range:

-420° to +1200°F

(-251° to +648°C)

BALL CHECK VALVES

| Catalog Number | Connection | MAWP | Cv | A | B | C | D |
|----------------|-------------------|------------------------|------|------------------|------------------|-----------------|-----------------|
| 60BC4 | 1/4" H/P Tube | 60,000 PSI 4140 bar | 0.15 | 3.31" (84.1) | 2.50" (63.5) | 1.12" (28.4) | 0.88" (22.2) |
| 60BC6 | 3/8" H/P Tube | 60,000 PSI 4140 bar | 0.28 | 3.75" (95.3) | 3.00" (76.2) | 1.38" (34.9) | 1.12" (28.4) |
| 60BC9 | 9/16" H/P Tube | 60,000 PSI 4140 bar | 0.63 | 4.57" (116.1) | 3.38" (85.9) | 1.50" (38.1) | 1.38" (34.9) |
| 40BC9 | 9/16" H/P Tube | 40,000 PSI 2760 bar | 1.00 | 4.57" (116.1) | 3.38" (85.9) | 1.50" (38.1) | 1.38" (35.1) |
| 30BC16 | 1" H/P Tube | 30,000 PSI 2070 bar | 3.40 | 6.50" (165.1) | 5.55" (141.0) | 1.75" (44.5) | 2.13" (54.1) |

To order a valve with a cracking pressure other than the standard 15 PSI, add the cracking pressure to the end of the catalog number. Example: A 60BC9 with 50 PSI cracking pressure would be ordered as **60BC9-50**.

Cracking pressures available up to 100 PSI (7 bar)

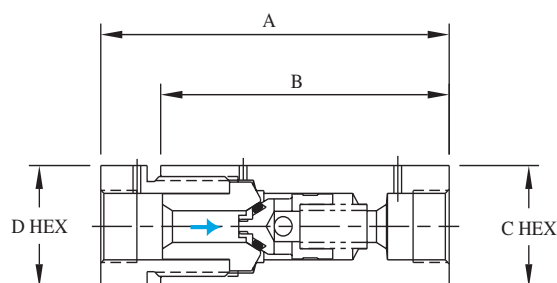

BuTech o-ring check valves reliably prevent backflow where leak-tight shutoff for liquids or gases is required. Standard materials of construction are 316 stainless steel with Buna-N o-ring and 300 series stainless steel spring.

Cracking pressure: 15 PSI (1 bar) approximate

Operating Temperature Ranges:

| O-ring Material | Operating Temperature Range | Catalog Suffix |
|-----------------|-----------------------------------|----------------|
| Buna-N | -65° to +250°F (-54° to +121°C) | ---- |
| Viton | -40° to +500°F (-40° to +260°C) | -VA |
| Teflon | -320° to +400°F (-195° to +204°C) | -TFE |
| Kalrez | -20° to +550°F (-29° to +288°C) | -HT |

O-RING CHECK VALVES

| Catalog Number | Connection | MAWP | Cv | A | B | C | D |
|----------------|-------------------|------------------------|------|------------------|------------------|-----------------|-----------------|
| 60SC4 | 1/4" H/P Tube | 60,000 PSI 4140 bar | 0.15 | 3.31" (84.1) | 2.50" (63.5) | 1.12" (28.4) | 0.88" (22.2) |
| 60SC6 | 3/8" H/P Tube | 60,000 PSI 4140 bar | 0.28 | 3.75" (95.3) | 3.00" (76.2) | 1.38" (34.9) | 1.12" (28.4) |
| 60SC9 | 9/16" H/P Tube | 60,000 PSI 4140 bar | 0.63 | 4.57" (116.1) | 3.38" (85.9) | 1.50" (38.1) | 1.38" (34.9) |
| 40SC9 | 9/16" H/P Tube | 40,000 PSI 2760 bar | 1.00 | 4.57" (116.1) | 3.38" (85.9) | 1.50" (38.1) | 1.38" (35.1) |
| 30SC16 | 1" H/P Tube | 30,000 PSI 2070 bar | 3.40 | 6.50" (165.1) | 5.55" (141.0) | 1.75" (44.5) | 1.75" (44.5) |

To order a valve with a cracking pressure other than the standard 15 PSI, add the cracking pressure to the end of the catalog number. Example: A 60SC4 with 40 PSI cracking pressure would be ordered as **60SC4-40**.

Cracking pressures available up to 100 PSI (7 bar)

LOW PRESSURE CHECK VALVES

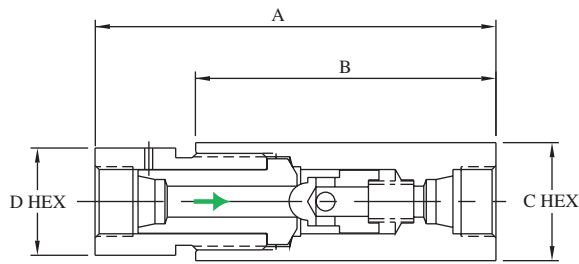

BuTech ball check valves prevent reverse flow where leak-tight shutoff is not necessary. Standard materials of construction are 316 stainless steel with 17-4PH poppet for longer life, and 300 series stainless steel spring.

Note: For 316 stainless steel wetted parts, add **-316WP** to the catalog number.

Cracking pressure: 15 PSI (1 bar) approximate

Operating Temperature Range:

-420° to +1200°F

(-251° to +648°C)

BALL CHECK VALVES

| Catalog Number | Connection | MAWP | Cv | A | B | C | D |
|----------------|----------------|------------------------|------|------------------|-----------------|-----------------|-----------------|
| LPBC2 | 1/8" L/P Tube | 15,000 PSI 1030 bar | 0.15 | 2.38" (60.5) | 1.88" (47.8) | 0.50" (12.7) | 0.62" (15.7) |
| LPBC4 | 1/4" SL/P Tube | 11,500 PSI 790 bar | 0.63 | 3.24" (82.3) | 2.62" (66.5) | 0.75" (19.1) | 0.81" (20.6) |
| LPBC6 | 3/8" SL/P Tube | 7,500 PSI 520 bar | 1.70 | 4.44" (112.8) | 3.50" (88.9) | 1.38" (35.1) | 1.38" (35.1) |
| LPBC8 | 1/2" L/P Tube | 5,500 PSI 380 bar | 3.40 | 4.67" (118.6) | 3.50" (88.9) | 1.38" (35.1) | 1.38" (35.1) |

To order a valve with a cracking pressure other than the standard 15 PSI, add the cracking pressure to the end of the catalog number. Example: A LPBC8 with 50 PSI cracking pressure would be ordered as **LPBC8-50**.

Cracking pressures available up to 100 PSI (7 bar)

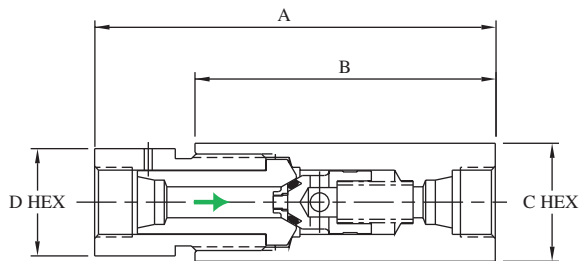

BuTech o-ring check valves reliably prevent backflow where leak-tight shutoff for liquids or gases is required. Standard materials of construction are 316 stainless steel with Buna-N o-ring and 300 series stainless steel spring.

Cracking pressure: 15 PSI (1 bar) approximate

Operating Temperature Ranges:

| O-ring Material | Operating Temperature Range | Catalog Suffix |
|-----------------|-----------------------------------|----------------|
| Buna-N | -65° to +250°F (-54° to +121°C) | ---- |
| Viton | -40° to +500°F (-40° to +260°C) | -VA |
| Teflon | -320° to +400°F (-195° to +204°C) | -TFE |
| Kalrez | -20° to +550°F (-29° to +288°C) | -HT |

O-RING CHECK VALVES

| Catalog Number | Connection | MAWP | Cv | A | B | C | D |
|----------------|----------------|------------------------|------|------------------|-----------------|-----------------|-----------------|
| LPSC2 | 1/8" L/P Tube | 15,000 PSI 1030 bar | 0.15 | 2.38" (60.5) | 1.88" (47.8) | 0.50" (12.7) | 0.62" (15.7) |
| LPSC4 | 1/4" SL/P Tube | 11,500 PSI 790 bar | 0.63 | 3.31" (84.1) | 2.62" (66.5) | 0.75" (19.1) | 0.81" (20.6) |
| LPSC6 | 3/8" SL/P Tube | 7,500 PSI 520 bar | 1.70 | 4.44" (112.8) | 3.50" (88.9) | 1.38" (35.1) | 1.38" (35.1) |
| LPSC8 | 1/2" L/P Tube | 5,500 PSI 380 bar | 3.40 | 4.67" (118.6) | 3.50" (88.9) | 1.38" (35.1) | 1.38" (35.1) |

To order a valve with a cracking pressure other than the standard 15 PSI, add the cracking pressure to the end of the catalog number. Example: A LPSC4 with 40 PSI cracking pressure would be ordered as **LPSC4-40**.

Cracking pressures available up to 100 PSI (7 bar)

MEDIUM PRESSURE CHECK VALVES

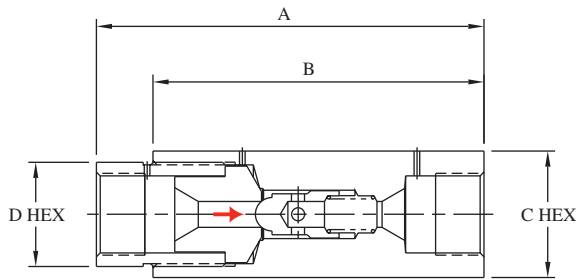

BuTech ball check valves prevent reverse flow where leak-tight shutoff is not necessary. Standard materials of construction are 316 stainless steel with 17-4PH poppet for longer life, and 300 series stainless steel spring.

Note: For 316ss wetted parts, add **-316WP** to the catalog number.

Cracking pressure: 15 PSI (1 bar) approximate

Operating Temperature Range:

-420° to +1200°F

(-251° to +648°C)

BALL CHECK VALVES

| Catalog Number | Connection | MAWP | Cv | A | B | C | D |
|----------------|-------------------|------------------------|------|------------------|------------------|-----------------|-----------------|
| 20BC4 | 1/4" M/P Tube | 20,000 PSI 1380 bar | 0.25 | 2.93" (74.4) | 2.50" (63.5) | 1.00" (25.4) | 0.88" (22.4) |
| 20BC6 | 3/8" M/P Tube | 20,000 PSI 1380 bar | 0.80 | 3.13" (79.5) | 2.62" (66.5) | 1.12" (28.4) | 0.88" (22.4) |
| 20BC9 | 9/16" M/P Tube | 20,000 PSI 1380 bar | 2.30 | 4.22" (107.2) | 3.50" (88.9) | 1.38" (35.1) | 1.38" (35.1) |
| 20BC12 | 3/4" M/P Tube | 20,000 PSI 1380 bar | 3.40 | 5.94" (150.9) | 4.75" (120.7) | 1.75" (44.5) | 1.38" (35.1) |
| 20BC16 | 1" M/P Tube | 20,000 PSI 1380 bar | 5.20 | 6.50" (165.1) | 5.55" (141.0) | 2.12" (53.8) | 1.75" (44.5) |

To order a valve with a cracking pressure other than the standard 15 PSI, add the cracking pressure to the end of the catalog number. Example: A 20BC9 with 50 PSI cracking pressure would be ordered as **20BC9-50**.

Cracking pressures available up to 100 PSI (7 bar)

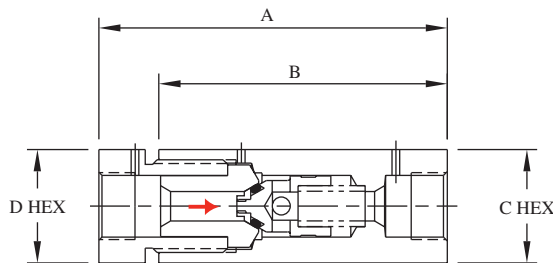

BuTech o-ring check valves reliably prevent backflow where leak-tight shutoff for liquids or gases is required. Standard materials of construction are 316 stainless steel with Buna-N o-ring and 300 series stainless steel spring.

Cracking pressure: 15 PSI (1 bar) approximate

Operating Temperature Ranges:

| O-ring Material | Operating Temperature Range | Catalog Suffix |
|-----------------|-----------------------------------|----------------|
| Buna-N | -65° to +250°F (-54° to +121°C) | ---- |
| Viton | -40° to +500°F (-40° to +260°C) | -VA |
| Teflon | -320° to +400°F (-195° to +204°C) | -TFE |
| Kalrez | -20° to +550°F (-29° to +288°C) | -HT |

O-RING CHECK VALVES

| Catalog Number | Connection | MAWP | Cv | A | B | C | D |
|----------------|-------------------|------------------------|------|------------------|------------------|-----------------|-----------------|
| 20SC4 | 1/4" M/P Tube | 20,000 PSI 1380 bar | 0.25 | 2.94" (74.7) | 2.50" (63.5) | 1.00" (25.4) | 0.88" (22.4) |
| 20SC6 | 3/8" M/P Tube | 20,000 PSI 1380 bar | 0.80 | 3.12" (79.2) | 2.62" (66.5) | 1.12" (28.4) | 0.88" (22.4) |
| 20SC9 | 9/16" M/P Tube | 20,000 PSI 1380 bar | 2.30 | 4.23" (107.4) | 3.50" (88.9) | 1.38" (35.1) | 1.38" (35.1) |
| 20SC12 | 3/4" M/P Tube | 20,000 PSI 1380 bar | 3.40 | 5.89" (149.6) | 4.75" (120.7) | 1.75" (44.5) | 1.38" (35.1) |
| 20SC16 | 1" M/P Tube | 20,000 PSI 1380 bar | 7.40 | 6.50" (165.1) | 5.55" (141.0) | 2.12" (53.8) | 1.75" (44.5) |

To order a valve with a cracking pressure other than the standard 15 PSI, add the cracking pressure to the end of the catalog number. Example: A 20SC4 with 40 PSI cracking pressure would be ordered as **20SC4-40**.

Cracking pressures available up to 100 PSI (7 bar)